

MSW-2

®

Operating Instructions



In certain applications with RESISTRON or CIRUS temperature controllers, it is necessary to detect short-circuits between the heatsealing band and ground or the housing. In this case, the control system must be immediately switched off. The MSW-2 monitoring current transformer can be used for this purpose.

If a frame current I_{GND} occurs between the heatsealing band and ground or the housing, it is detected by the current sensor of the MSW-2 and transmitted to the controller via the current measuring wire I_R . The controller then reports an alarm (if present).

Although the MSW-2 contains active components, no additional power supply is required.

The MSW-2 monitoring current transformer is only allowed to be operated if it is correctly connected to the temperature controller (refer to the "Startup" and "Power supply" sections in the controller documentation).

! Only the original ROPEX MSW-2 current transformer is allowed to be used. Other transformers may cause the equipment to malfunction.

Dimensions

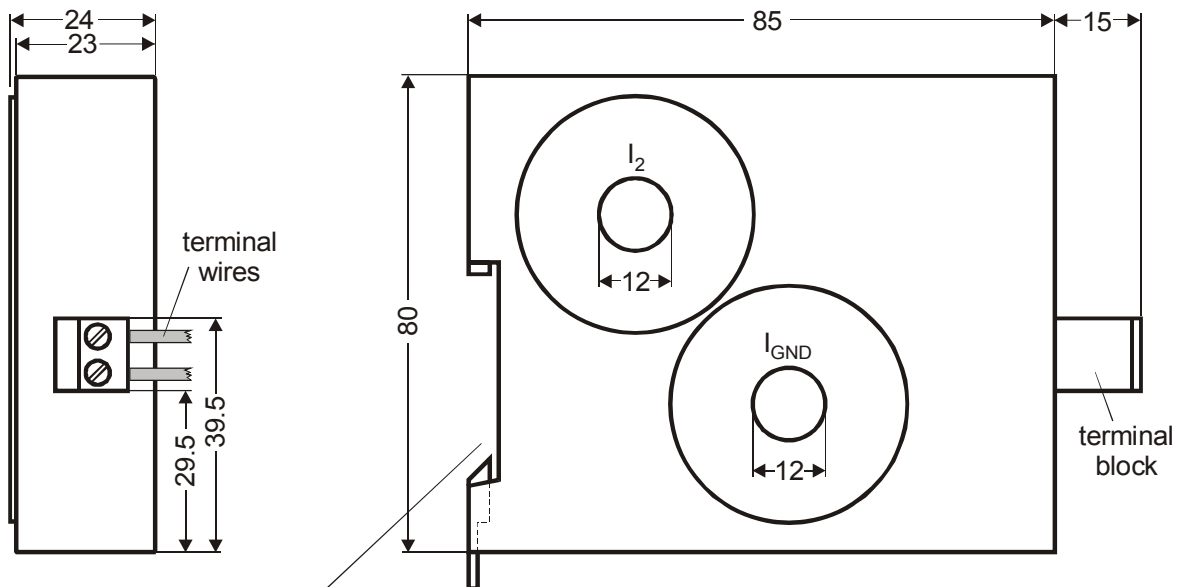

Snap-on for DIN-rail 35 x 7,5mm or 35 x 15mm (DIN EN 50022)

Technical data

Type of construction	Housing for installation in the electrical cabinet Snaps onto a standard top hat rail (DIN TS35 rail, 35mm) acc. to DIN EN 50022 Dimensions: 100 x 24mm; height: 80mm (incl. terminals)
Power dissipation	max. 5.0W
Response threshold I_{GND}	Approx. 0.5A
Ambient temperature	+5...+45°C
Degree of protection	IP20
Installation	<p>If several controllers are installed on one top hat rail (DIN TS35 rail), a clearance of at least 20mm should be allowed between them.</p> <p>The moving clip required for fastening must be facing down for mounting on a horizontal top hat rail.</p> <p>End holders to mechanically fix the controller must be fitted at both ends for mounting on a vertical top hat rail.</p>
Weight	Approx. 0.40kg (incl. connector plug-in parts)
Housing material	Plastic, polycarbonate, UL-90-V0
Connecting cables Type / cross-sections	<p>Rigid or flexible; 0.2...1.5mm² (AWG 24...16) with plug-in connections</p> <p>⚠ If ferrules are used, they must be crimped in accordance with DIN 46228 and IEC/EN 60947-1. This is essential for proper electrical contact in the terminals.</p>

How to order

	Monitoring current transformer MSW-2 Art. No. 885212
---	---